



— LEADING THE WAY —

Laminator



Operating instructions

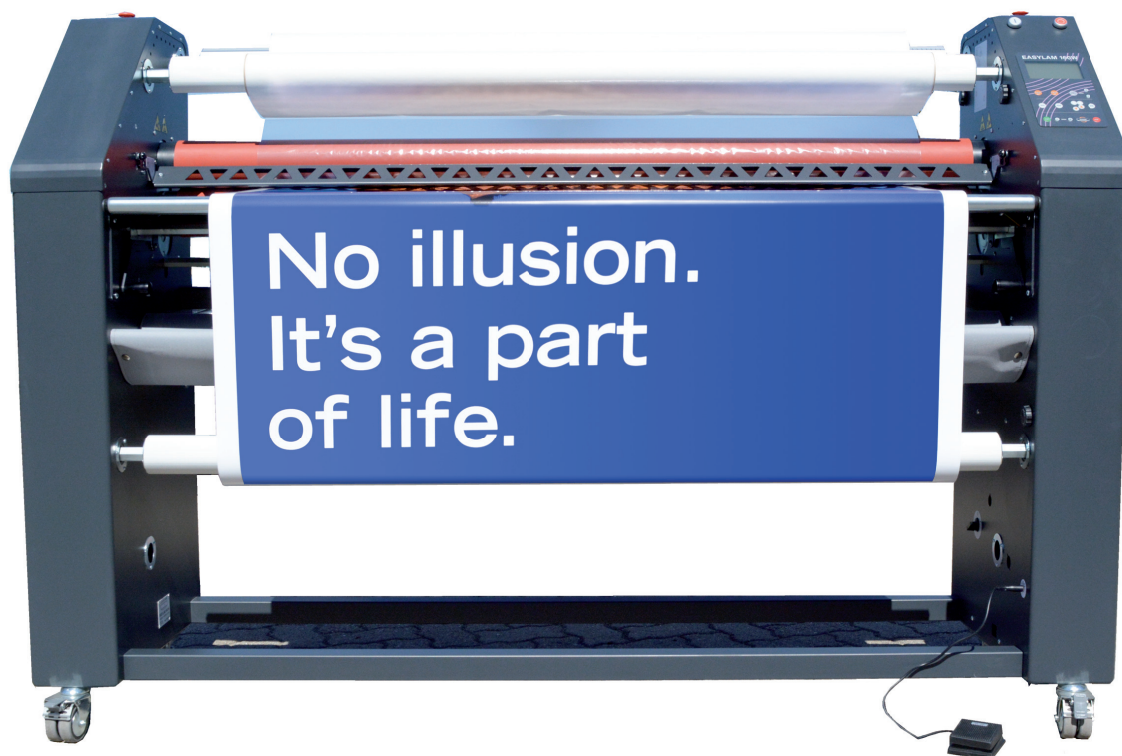

**Please read this operating instructions before installation and keep this
for later use**

technical information

model	EASYLAM 160W
length	206 cm
width	58 cm
height	143 cm
height working area	104 cm
max. media width	169 cm
usable roll length	1640 mm
max. opening of rolls	40 mm
power supply	110 - 230 V
.....	50/60 Hz max. 16 A

INSTALLATION

The laminator is delivered in wooden box.

size216 x 162 x 72 cm

weight in total incl wooden box kg410 kg

To open the box we recommend to use a cordless screwdriver. Further you need a open-end wrench,
size 17

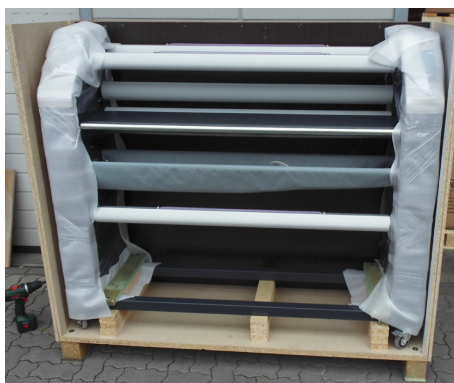

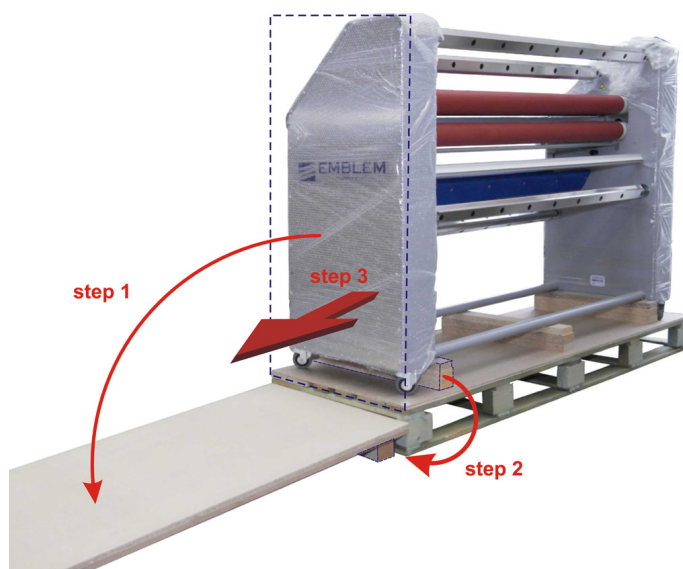

Further advises for installation:

Power supply:

The connection sockets have to be close to the machine.

- AC voltage 110 V - 230 V
- frequency: 50 – 60 Hz
- strength of electric current: 16 A

Location

The location to place the machine must provide enough space to work. Don't forget that space is also needed to insert and remove the material. Please consider the dimensions of the pictures and sheets used.

Place

Prepare a flat location suited to the size of the machine and also consider its accessories.

Lighting

Good lighting (300 – 600 lux) is indispensable to operating and maintaining the machine safely.

Room properties:

The laminator has to be placed in a closed room and has to be protected against weather effect.

- Permissible room temperature: 18°C to 35°C.
- Humidity range permitted: 30% to 80%

Electricity connection

Check that the electrical supply corresponds with the machine performance.

With connecting to the electricity supply, the laminator must be earthed.

To connect the laminator with electric supply system:

- Interrupt the current supply.
- Connect the connection cable to a suitable plug or directly to the main (capsule rail, junctionbox, etc.).
- Turn on the electricity with main switch (10).

Test before use

Before the actual initial operation, carry out a few test runs of the different functions of the device.

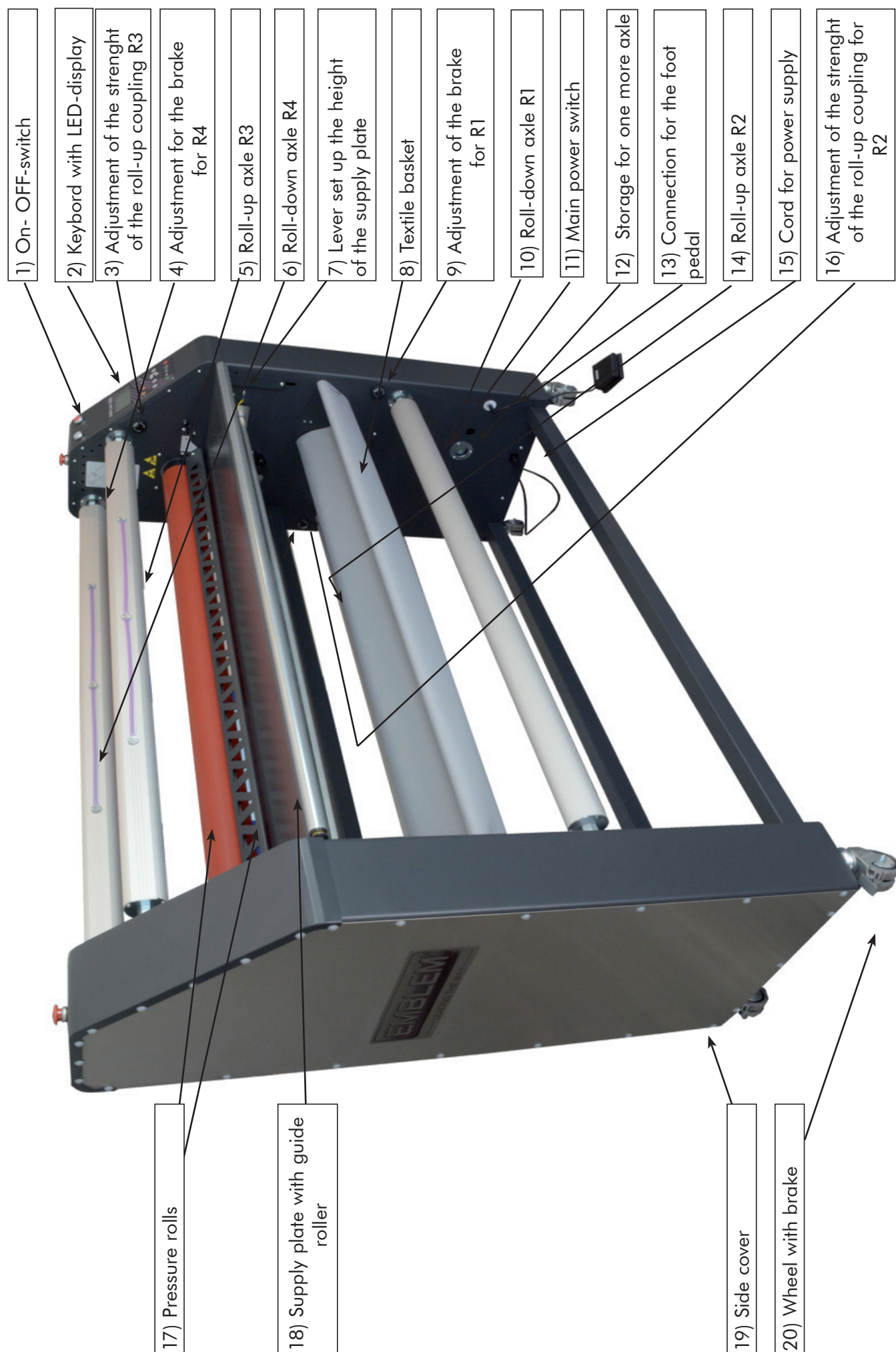

Keyboard with LED display

The laminator is controlled (apart from footpedal) by the following keyboard:

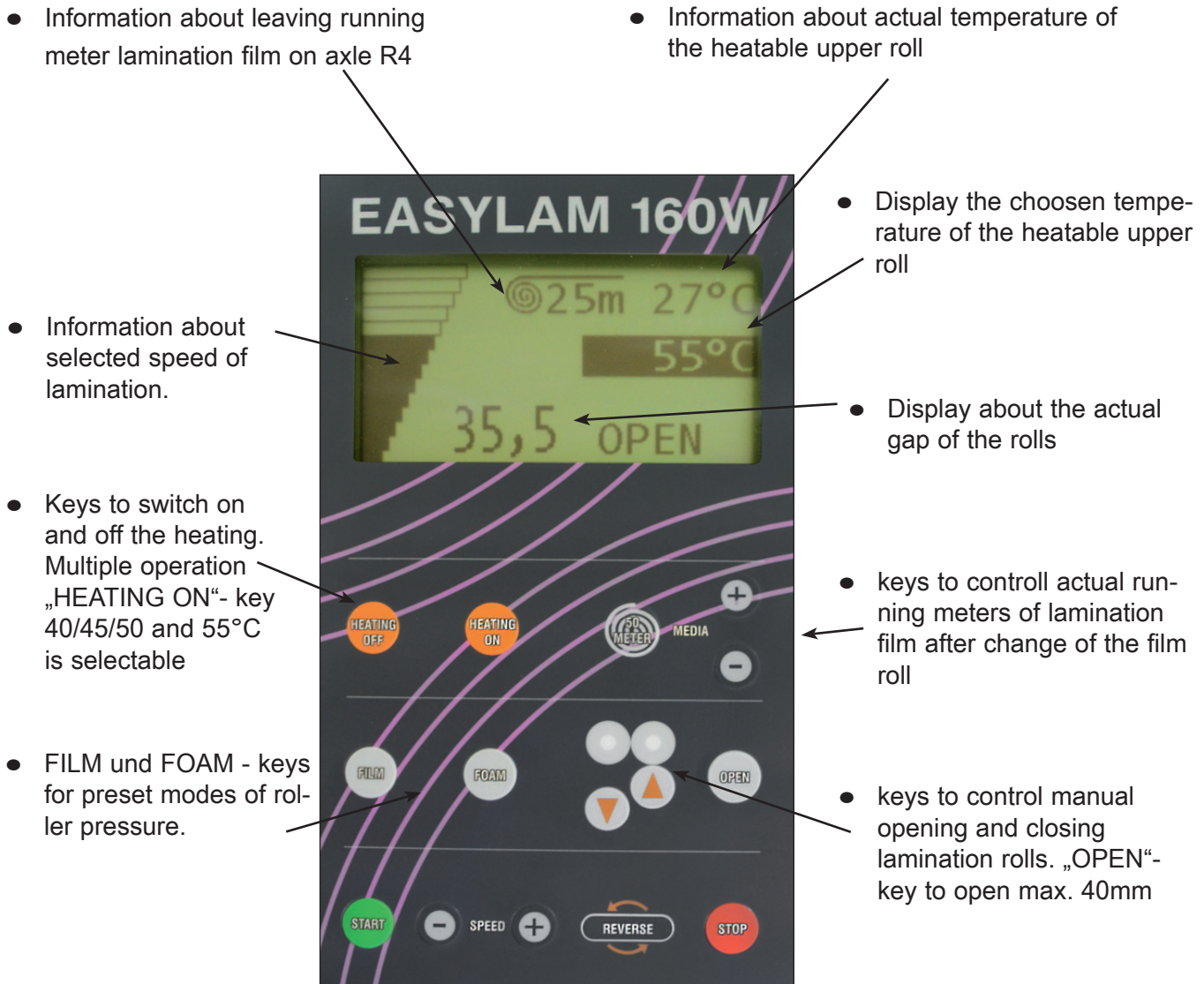

- START/STOP – starts and stops rolls runningt. Alternative the pedal start and stops the lamination rolls.
- SPEED „-“ and „+“ changes the speed of lamination process
- REVERSE – laminator stops and runs backwarts slowly

By pressing the FILM button, the machine will automatically regulate the pressure depending on the temperature. The display shows following:

Temperature higher than 50°C >	„FILM“
Temperature between 40°C and 50°C >	„FILM-1“
Temperature between 30°C and 40°C >	„FILM-2“
Temperature lower than 30°C >	„FILM-3“

Safety devices

The machine includes the following safety devices:

- Left safety cover
- right safety cover
- protection bar
- Emergency stop key left and right

Make sure that your hands do not get between the rolls while the machine is operating. EMBLEM EASYLAM 160W is equipped with a protection bar. In this way serious injuries or pinching of the fingers are avoided. Further this protection bar has to make sure that no parts of the body or other unknown objects get between the rolls. The manufacturing company will not accept any liability - especially in case of any mechanical or electrical alteration of the mechanism by the user.

The side covers are designed to protect the electric equipment of the machine and may be removed by qualified personal only or by service technicians authorised by the manufacturer.

Operation of the machine

When you start working stay directly in front of the machine. The laminator has to be turned on with the main switch (right down, inside the machine). The main switch is lighted in green.

On top of the keyboard you find the „ON“- and „OFF“-switches.

General operation advice

Axles R1-R4 are equipped with adjustable brakes and clutches. All mediums have their own specifications, which differ by temperature, humidity, used glue, type of film and more. The best condition is, when the lamination film is tensioned at the upper roll and can be applied without wrinkles. To find the best adjustment you start with low brake condition. If necessary you can increase the break power. We recommend not to use too much brake to get not too much tension. The lamination film would warp too much and the laminated product would get too much tension. Using the take up for liner you need low tension. Please notice to adjust the clutches properly.

Operation of the machine

The machine may be used only by trained and qualified personnel.

To set the pressure correctly you can either use the preset functions „FOAM“ or „FILM“. You can use also the manual function with arrow-keys up or down. „FOAM“ is for foam boards or other not rigid media. „FILM“ is for paper, film and self adhesive vinyl. To get the correct right pressure, we recommend to make tests sample.

When the roller pressure is exceeded to a damaging extent, the machine stops automatically.

To avoid tension and pushing, the material to be worked with should be placed in the middle, i.e. at an equal distance from both sides; the same applies to small formats (e.g. for a roller width of 1,450 mm and a material of 450 mm).

When laminating thin film or paper, it is important to choose the width of the laminate according to the dimensions of the picture. It should not protrude too far over the print to be laminated as otherwise it could stick to the lower roller. It is perfect if the paper to be laminated or the base is bigger than the laminate to be applied.

If this is not possible, the size difference between the laminate and the paper has to be kept as small as possible (no more than 2–3 cm per page) to avoid creases.

Material supply

The media axles (R1 - R4) could be equipped with lamination film, liner or double sided adhesion film. To place the axes, please notice the pictures and the following descriptions:

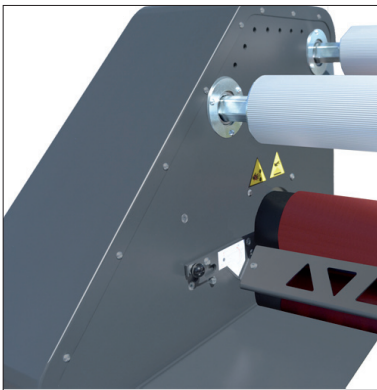

Plug-In the scroller

The scrollers are hexagonal and can be pushed on left side into the bearings. It necessary to use some power because you have to work against some spring force.

Remove the scroller

Push the axle to left all the way to the stop and keep position. Move out the axle right out of bracket and move it to front. Get out the axle from the left bracket

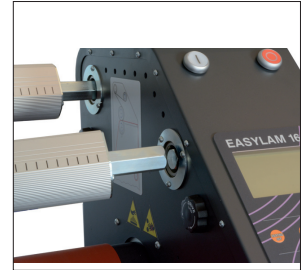

Autogrip-material insertion

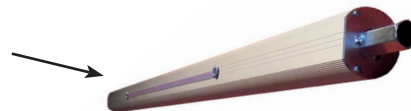

Move the scroller into the core of media, you want to use. The autogrip-material support makes it easy to move it inside. As soon the laminator motor will drive this scroller, the core is fixed automatically and will rotate with the scroller.

Autogrip-material insertion



Operating principles:

Adhesives without protective liner (application tape, double-sided adhesive film):

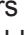
- Open the lamination roller by pressing the button  and put on the laminate flatly. Ensure that the film is completely flat on the roller and there are no folds or waves. Secure the film by fastening (tape) it slightly onto the back workspace.
- Use the button  to close the gap to about 1 cm off. Meanwhile the film might come loose during this time and no longer stick to the roller perfectly. Pull the film straight again so that it is slightly under tension.
- After you have put the print to be protected under the laminating roller, use  and  to adjust the rollers completely or use „FOAM“ or „FILM“ to shut the rollers automatically. If the print medium is not stiff, put on the laminate that it extends to the work surface via the rubber roller and the slit so it sticks when the machine starts up.

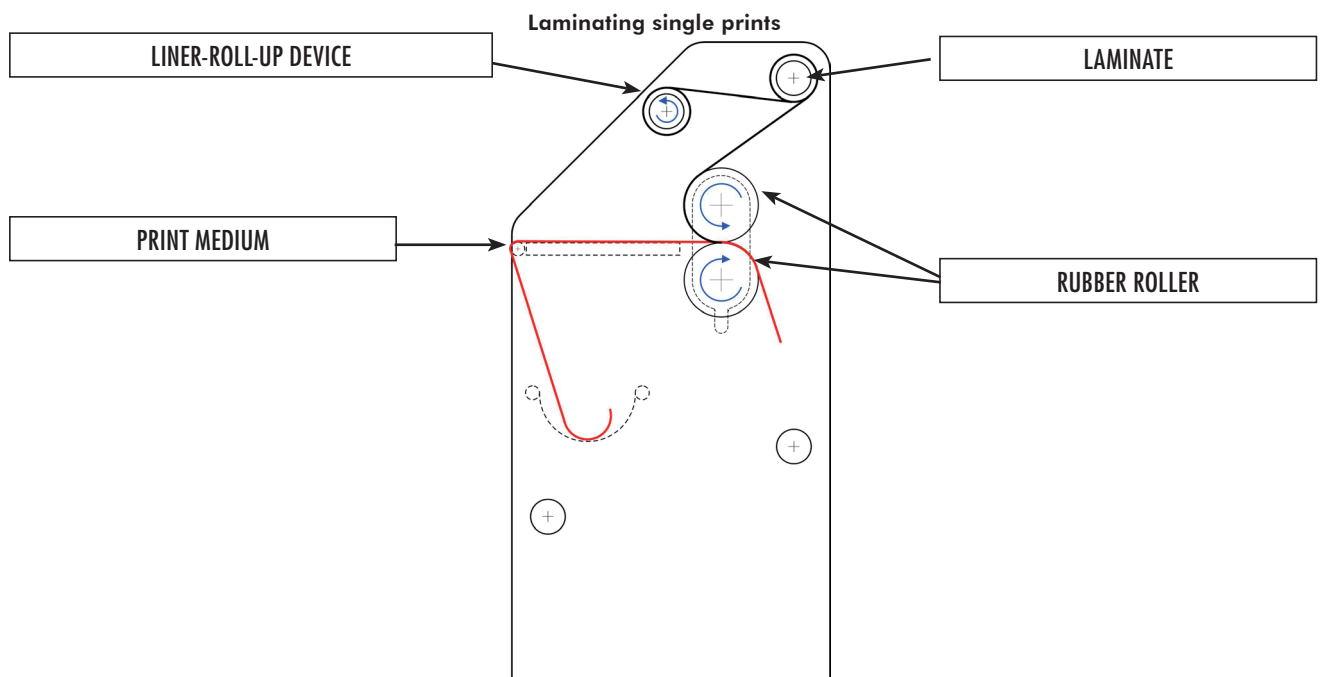

EASYLAM-CUTTER

To equip your laminator with lamination film in a simple and economical way we recommend our EASYLAM-CUTTER (Art.-Nr.: 24959).

Its knife has a special blade to minimize the danger of getting hurt or of damaging the rolls considerably.

Advantages:

- you save time and material while inserting the lamination film including liner
- no exposed knife point

The following description of the procedure allows an economical consumption of the lamination film while equipping the laminator with foil. The cutter simplifies the preparation of the machine and helps to learn it faster.



You can get this tool at your local dealer or at www.dataplot.de.

Place the lamination film between the rollers

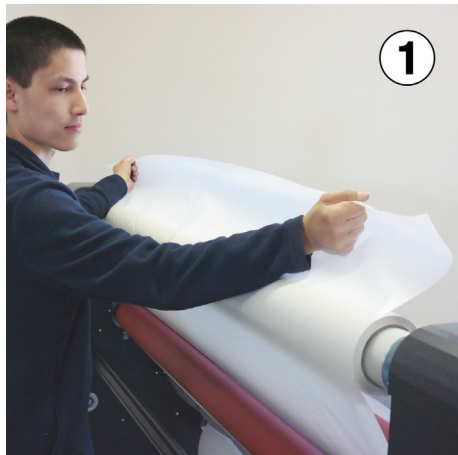

Hold the film tight and clamp the rollers



Make sure the lamination film is rolled tight

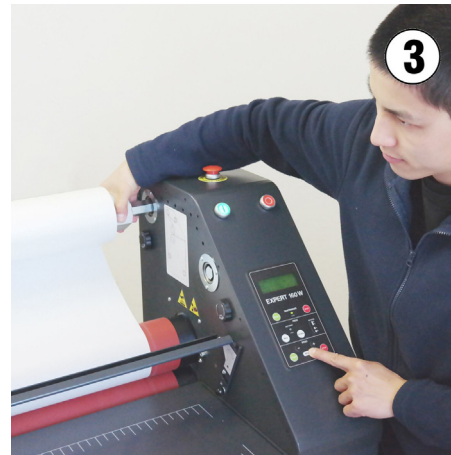

Feed forward approx. 5cm of lamination film

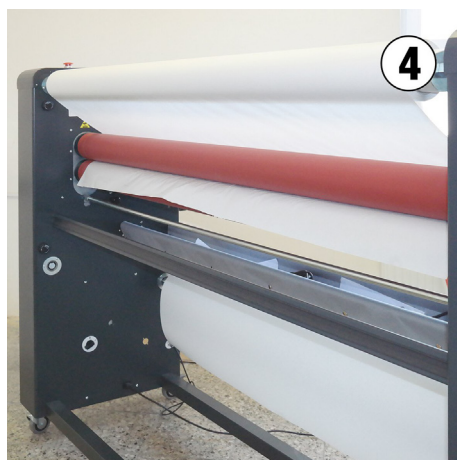

Position the blunt part of the knife between film and liner

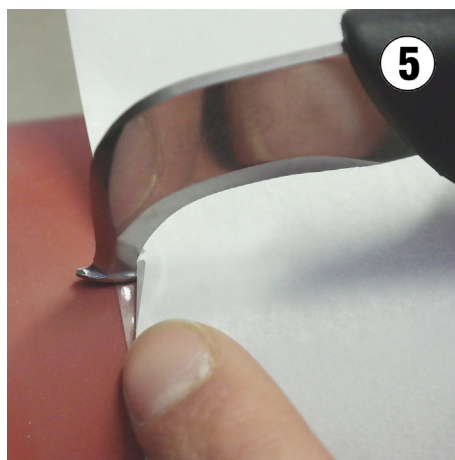

Cut the liner carefully

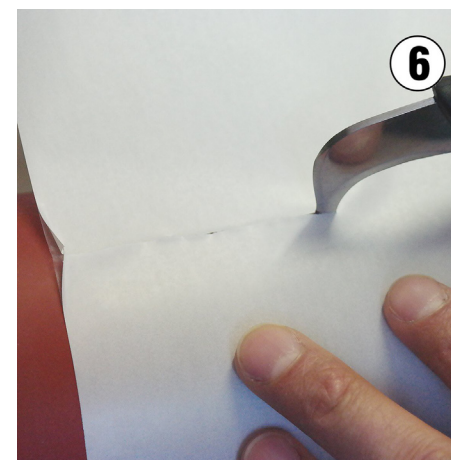

Use the sharp end in front of the knife too

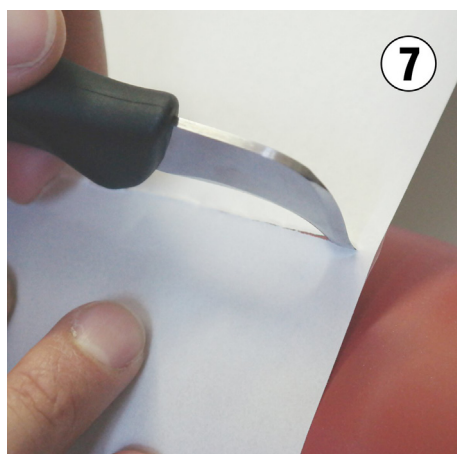



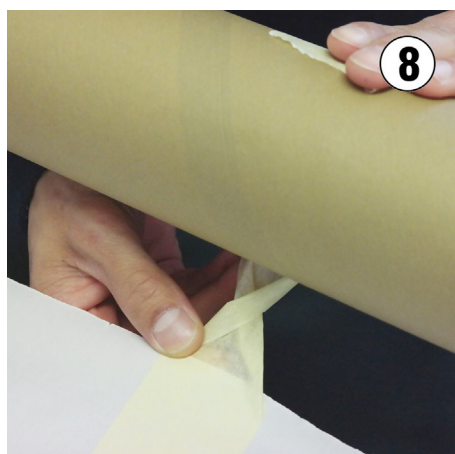

Fix the liner to the core

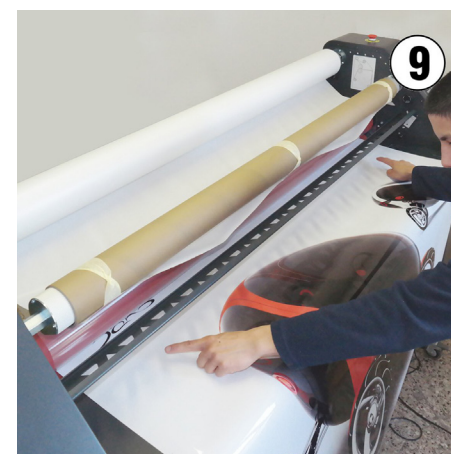

Start Laminating



Laminate with backing paper / liner:

- Open the lamination roller by pressing the button  or „OPEN“ (see page 5) and put in the laminate as shown in the picture. Push an empty roller core onto the roll-up axle R3 so that the protective liner/backing paper can be rolled up.
- After you have attached the laminate to the roll-down axle R4, separate the backing paper and use tape to fasten it to the cardboard core on the roll-up axle R3. Ensure that the protective liner has been fastened uniformly without cross creases. Pull the laminate between the rollers and stick it onto the upper roller with tape. When doing this ensure that the foil is spread out evenly across the whole width. If there are creases or folds, repeat the steps until the material is perfectly positioned.
- By adjusting the coupling of the roll-up axles the pull of the R3 axle can be stopped. Only a small amount of power is required to roll up the liner. Therefore, do not select a very high value.
- The required breaking power is normally low unless the protective liner has much more power than the vinyl. In this case the tensile force has to be increased accordingly.
- Use the button  to close the gap to about 1 cm off. The laminate might come loosen during this time and no longer stick to the roller properly. Correct the film again.
- Put the print to be laminated between the laminating rollers as shown in the picture. Use  and  to adjust the rollers completely or use „FOAM“ or „FILM“ to shut the rollers automatically.
- Release the film that you have fixed with tape to the upper roller and start running the machine.

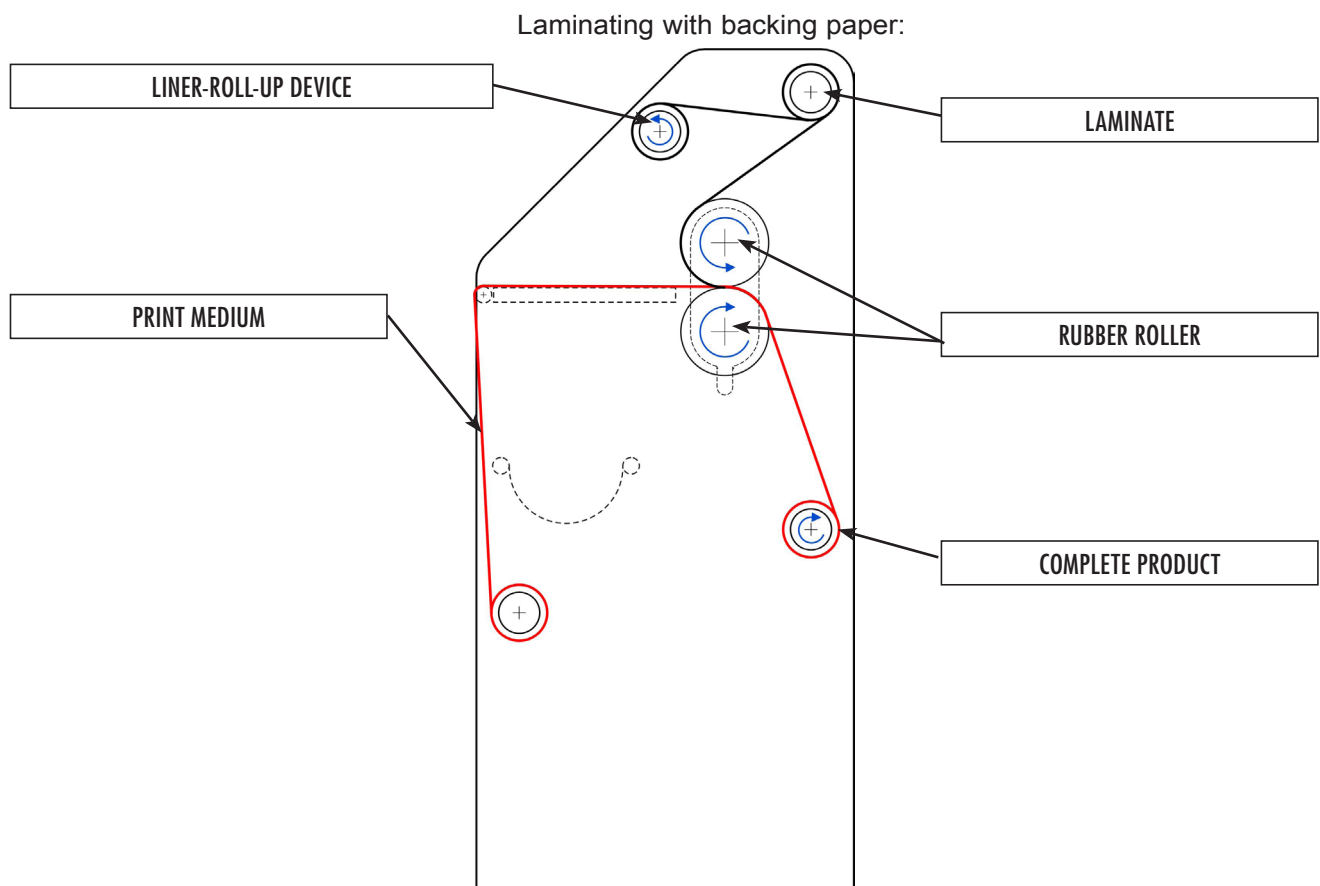

Proceed as described above for simultaneous lamination of both sides. Also use the roll-down axle R1 and roll-up axle R2

- First mount the material and the empty roller core onto the lower roll-down and roll-up axles R1 and R2
- Both cores used have to be of the same width. Mount them so that they are line up precisely with each other. To achieve this, measure the distance to both sides of the rollers.

Mounting already laminated paper material to a sheet.

- Take a base plate that is already equipped with double-sided adhesive film.
- Set the height of the supply plate.
- Pull off 3-4 cm of the protective liner from the adhesive film to free the adhesive layer. Centre the picture on the plate by laying it over the part which is still covered by the liner and stick it to the exposed surface. We recommend sticking it by beginning in the centre and moving to the outside. Ensure that no creases and waves form in the paper. So you prevent a negative effect on the rest of the process. Guide the sheet between the open rollers. Ensure that the middle of the rollers is covered by the point where the picture lifts off the double-sided adhesive film. Position the object which will be laminated over the lower pressing roller in a way that it lays flat on the upper roller.
- Now push the buttons „FOAM“ or „FILM“ and start the laminator. To receive the finished product, you can proceed in two different ways:

METHOD no. 1

Application of the double-sided
adhesive film to the sheet
Lamination of the picture
Mounting the picture to the sheet

METHOD no. 2

Application of the double-sided
adhesive film to the sheet
Mounting the picture to sheet
Lamination of the picture already on the sheet

Method 1 involves lamination between both rollers whose surfaces are perfectly flat and therefore ensures an optimal result. Method 2 involves layering between the upper roller and the sheet onto which the picture has already been laminated. If the sheet only has slight bumps, the result could be unsatisfactory. Zones might form where there is less pressure, creating undesirable light effects. We recommend method 1 for an all-over good result. Method 2 may be shorter, but it is up to the user to decide which is the best method.

Application to sheets of double-sided adhesive film

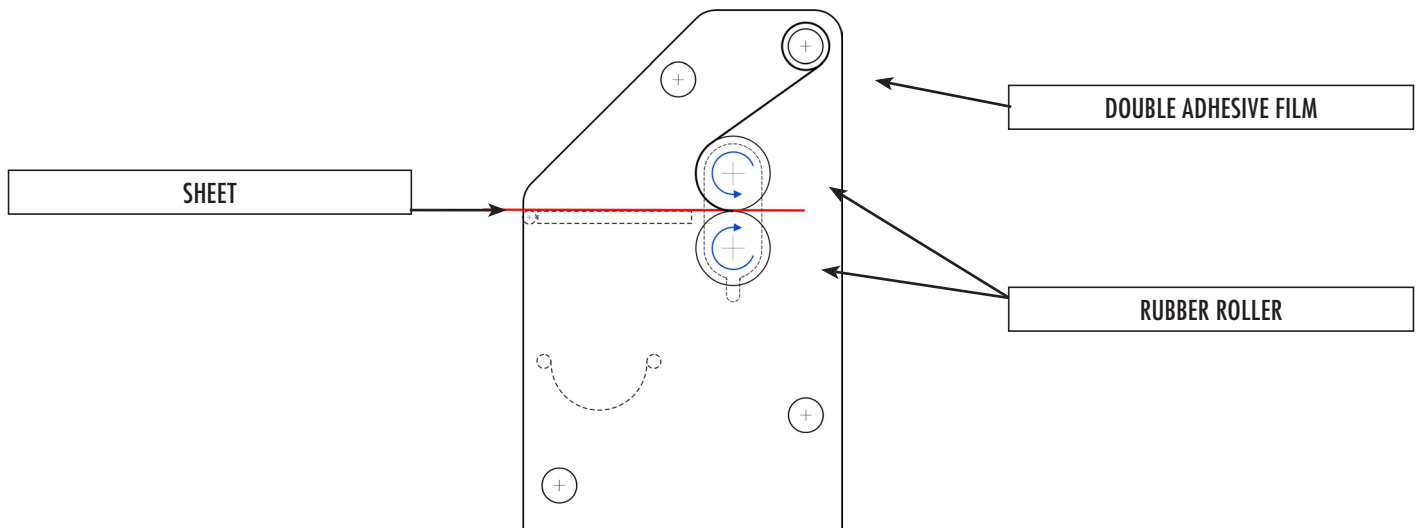

Montage von geschütztem mit doppelseitiger Klebefolie beschichtetem Bild

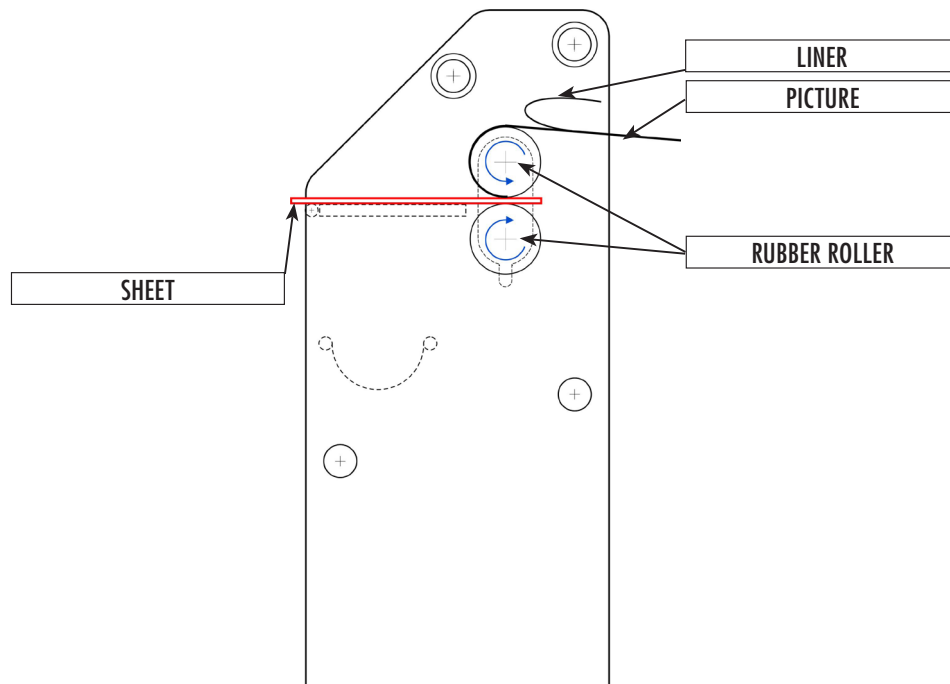

Montage von geschütztem Bild auf eine bereits mit doppelseitiger Klebefolie beschichtete Platte

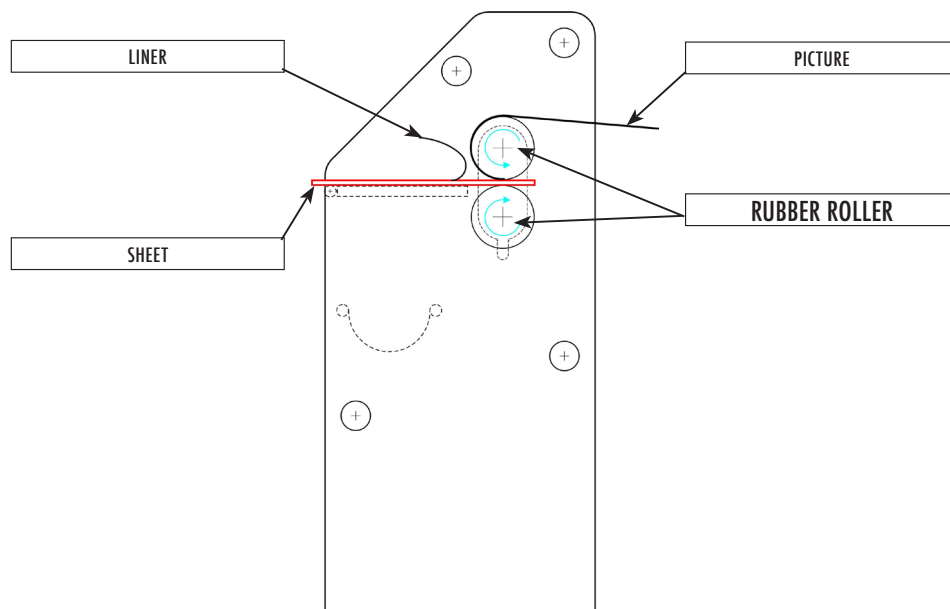

CE DECLARATION OF CONFORMITY

Us,

DATAPLOT GmbH
Gutenbergstraße 15
24558 Henstedt-Ulzburg

Company manufacturer of the brand **EMBLEM**, declares under our own responsibility, that the machine:

Brand:	EMBLEM
Model:	Easylam Expert 140C
	Easylam Expert 160C
	Easylam 160W

Is in conformity with:

The requirements of EU Directive 2006/42/EC.

The requirements of EU Directive 2004/108/EC.

The safety requirements of EU Directive 2006/95/EC.



Dataplot GmbH • Gutenbergstraße 15 • D-24558 Henstedt-Ulzburg • Germany
Tel. +49 41 93 995 0 • Fax +49 41 93 995 220
info@dataplot.de • www.dataplot.de